

Foam 2 Foam is a single part quick-drying adhesive for Depron, EPP and EPO foam, together with wood, plastic and a variety of other materials. Super 'Phatic! is a non-fuming alternative to cyano and is suitable for most materials such as foam, plastic, balsa, ply and carbon fibre parts. It is thin, easy-wicking and adds very little weight.



BUILDING A SCRAPPEE STAGG

John Bristow shows how to use 'Foam 2 Foam' and 'Super 'Phatic' adhesives from the Deluxe Materials to build a Microaces Staggerwing kit

words & photos » John Bristow

1



Scrappee STAGG from Microaces is a 427mm span staggered wing biplane based on the Beechcraft Model 17. The kit contents include a bundle of accessories plus laser-cut 1mm and 2mm Depron parts, polypropylene sheet and polyester sticker sheets, pre-printed in 1930s style USAAC liaison aircraft livery. Perfect for our choice of Super 'Phatic and Foam 2 Foam adhesives.

Kit contents and the Deluxe Materials adhesives used in its construction.

2



Assembly begins with laminating the foam keel with its plastic doublers using Foam 2 Foam. This is set aside to dry. Foam 2 Foam has a very high tack, but it allows the parts to be carefully positioned and accurately aligned before it dries.

3



Super 'Phatic is perfect for this task as it wicks into the joint and gives a lightweight and strong bond.

4

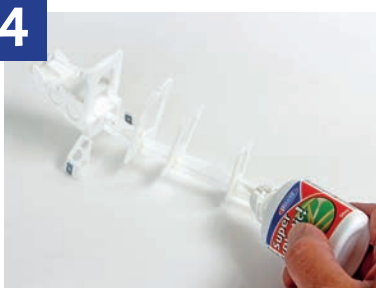

With the formers accurately positioned on the keel, Super 'Phatic can be wicked into both sides of each joint.

5



With some fine pencil guidelines marked on the fuselage it is easy to apply adhesive to each former's position.

6



The fuselage has been scored and bevelled before it is attached to the former and lower keel assembly using Foam 2 Foam.

7



Using the tip of the tube it is possible to add a little more Foam 2 Foam to the joints to ensure a perfect bond.

8



More pencil guide lines have been used so that the Foam 2 Foam adhesive can be positioned accurately on the fuselage sides.

9



With the bottom of the fuselage scored and bent to fit between the undercarriage legs, Foam 2 Foam is added to keel and formers.



Build & finish in a day



'The strength inside your model'

Fast & easy way to finish a foam or balsa model. Eze-Kote BD37



- Cleaner than epoxy
- Non-sticky
- No smell
- No waste
- Clean brushes in water. Saves time
- Accepts most paints
- Foam safe

Easily brushes through glass cloth onto foam



Finished, painted & ready

Photo Bob Benjamin rcmodel.com

Find out more

deluxematerials.com

10



Thin carbon fibre is added to the elevator's hinge line. Super 'Phatic is perfect for this task. Any excess can be wiped off before it dries.

11



The carbon fibre can be accurately aligned with the pre-cut Depron elevator's hinge line before the Super 'Phatic dries.

12



Foam 2 Foam is used to attach the central elevator hinge and horn mount. The assembly can then be set aside to dry.

13



Once the elevator has been hinged, adhesive is added to the rear of the fuselage where the tailplane is fitted.

14



Foam 2 Foam has a very quick grab time so a joint like this can be aligned and held in position by hand until the glue begins to dry.

15



A thin bead of Foam 2 Foam is used to glue each wing panel together. It's simple to do as the glue isn't at all 'stringy' in use.

16



As the fin locates in slots in the tailplane a small bead of adhesive on its base is sufficient to hold it firmly in place.

17



The rear of the motor cowl can now be firmly attached to the top cover. Small strips of tape were used to hold things in position as the glue dried.



For a durable, hard, lightweight finish Aeropoxy

Aeropoxy is super-thin epoxy for wing skinning, laminating & moulding. It increases surface toughness and strength resulting in a durable, hard, lightweight finish.

- Fuel proof
- Sands easily
- Sets in 24-36 hours



Easy 3:2 mix by weight



Super thin. Easily brushes into fibreglass cloth



Beautiful finish for paint



Ideal for lightweight fibreglass cloth
B11 24 gsm
B12 34 gsm &
B13 51 gsm

Find out more

deluxematerials.com

18

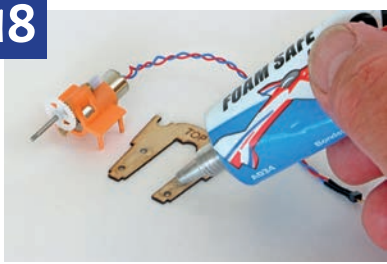

A couple of small beads of glue were used to attach the motor and gearbox assembly to the pre-cut plywood motor mount.

19



The lower wings are made in a similar manner to the upper wings. Foam 2 Foam is run along the top and bottom joint, plus the spar.

20

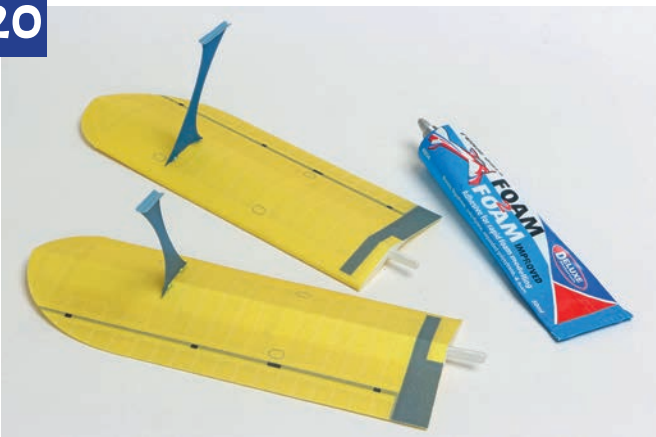

As it remains slightly flexible when dry a small amount of Foam 2 Foam is all that's needed on the locating tabs to install the interplane struts.

21



Super 'Phatic and Foam 2 Foam make assembling this small Depron model a real pleasure.

22



As Foam 2 Foam dries strong, flexible and clear it is perfect for the majority of the build, while Super 'Phatic penetrates much further than other glues to give high strength. Odour free in use too! ✈️



For ULTIMATE Protection & Gloss Finish

Aerokote

The ultimate finishing technology



- Tough, protective & fuel proof
- Incredible high gloss or adjustable matt finish
- Dries to dust free finish in minutes
- Prepares EPO foam for painting

'See what it can do!'

Transform painting of foam models



- Ultimate gloss finish to protect paint, film & trim
- Surface primer to assist paint adhesion on EPO foam (always test first)

Make It Matt BD61. Combine with Aerokote for semi or dead matt finish



Distributed to all good model shops ripmax.com

In Australia hobbiesaustralia.com.au

In North America horizonhobby.com
In case of difficulty towerhobbies.com

In case of difficulty deluxematerials.com

