

Electric Motors

Flight Gearboxes

Designed for Graupner's Speed 400 series and many other similar motors with 2.3mm Ø shafts. Supplied with a brass pinion that must be pressed onto the motor shaft. Double ball-raced output for minimum friction. M-1704/50 designed to suit Speed 500 motors (10.8mm collar).

M-1703/03	2.33:1 Gearbox for 1703/23	£17.50
M-1703/08	1.85:1 Gearbox for 1703/18	£17.50
M-1704/50	Gearbox 3:1 Reduction 10.8 mm	£14.99

For motors with a 13mm collar diameter and 3.17mm motor shaft, such as M-1757, 1758, 1763, 1772 and 1799.

M-1795/50 3:1 Reduction Gearbox.....£12.99
Suitable for 540~600 size motors with 3.2mm shafts to suit many Kyosho EP aircraft.

Z-K/90475-54 Gearbox with 3:1 Gear£6.99

A 2.5:1 ratio gearbox including steel pinion gear with ball-raced output shaft, machined aluminium prop driver, mounting screws, allen keys and instructions.

M-GPMG0850 GD600 Electric Gear Drive 2.5:1£ 18.99



Centreline Gearboxes

This range of centre shaft, high efficiency, electric flight gearboxes feature a glass filled nylon 3 piece casing, twin ballraces and helical final drive gears with a 5mm diameter



output shaft. Available in two versions to accept motors with either 3.2 or 5mm output shafts.

M-RMX521	Centreline Gearbox	2:1	5.0mm Motor Shaft	6-8 Cells	£29.99
M-RMX531	Centreline Gearbox	3:1	5.0mm Motor Shaft	8-10 Cells	£29.99
M-RMX831	Centreline Gearbox	3:1	3.2mm Motor Shaft	6-8 Cells	£29.99
M-RMX841	Centreline Gearbox	4:1	3.2mm Motor Shaft	8-10 Cells	£29.99
M-RMX851	Centreline Gearbox	5.5:1	3.2mm Motor Shaft	8-10 Cells	£29.99

Ducted Fan Units

Kyosho's fan unit as used in their T-33 and F-16 features a strong, lightweight, resin impeller, stator and cowl. When powered by Kyosho's AP29L Special Motor (M-K70851) this unit produces in excess of 400g of thrust.

M-K/DF01	EP Ducted Fan Unit without Motor	£26.99
M-K/DF01-01	Impeller Only For M-K/DF01	£5.75
M-K/DFW01	Aluminium Impeller Hub for M-K/DF01	£13.99
M-K/DFW02	Aluminium Spinner for M-K/DF01	£13.99

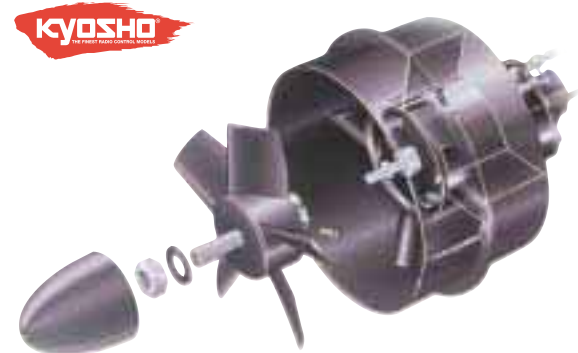

M-K/DF01

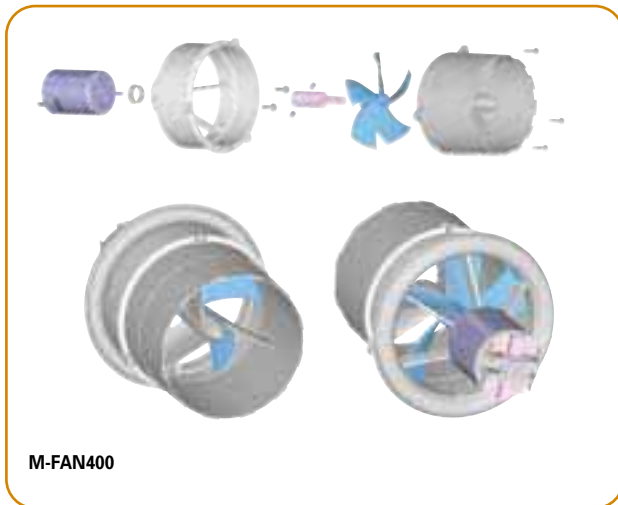
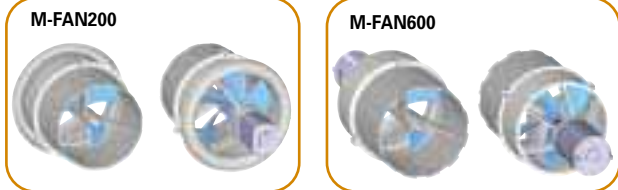

M-FAN400

Fantexx Ducted Fan Units

This superb new range of electric ducted fan units have been developed using the latest research and CAD/CNC technology to give the utmost in performance and efficiency. With three sizes in the range there is a fan unit to suit almost any application.

Features:

- Forward mounted motor to reduce drag
- Radical fan design with winglets to increase thrust
- Optimised stator profiles for maximum exhaust velocity
- Various motors can be fitted to give required performance
- Capable of being fitted with 7.2~12v motors

Part No.	Description	Length	Outer Ø	Fan Ø	Motor	Thrust	Price
M-FAN200	Fantexx 200	75mm	54mm	50mm	200-280 size	55-300g	£25.99
M-FAN400	Fantexx 400	88mm	62.3mm	60mm	400-480 size	300-600g	£29.99
M-FAN600	Fantexx 600	106.5mm	79mm	75mm	540-600 size	500-1000g	£34.99

Supplied without motor