

# Ripmax

## ROCK RACER



Congratulations on your purchase of a Ripmax Rock Racer, please read these instructions carefully and fully before use and we hope you enjoy your car.

### Specifications

- Car Scale: 1:24
- Car Battery: 6.4V 320mAh LiFe (Inc.)
- Car Dimensions: 201 x 110 x 74mm
- Driving Max Speed: 25km/h (Approx)
- Driving Time: 15min (Approx)
- Car Charging Time: 60min (Approx)
- Charger Input: 100-240V 50/60Hz
- Charger Output: 6.4V 350mAh
- Tx Max Control Range: 30-40M
- Tx Frequency: 2.4GHz
- Tx Battery: 3 x 'AA' 1.5V (Req.)
- Tx Dimensions: 118 x 72 x 179mm

### Parts and Functions

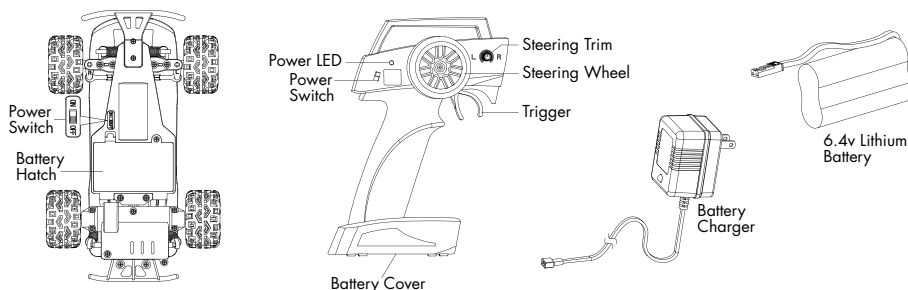

### Battery Installation Guide

As shown in diagram 1, open the remote control battery cover. Install three 'AA' batteries taking care to note the polarity matched the diagram in each battery slot. Re-install the cover to secure. Check the transmitter power switch is OFF and that the steering trim is centred vertically (diagram 2) before proceeding.

As shown in diagram 3, open the car battery bay by unscrewing the retaining screw and releasing the clip. Insert the battery (checking polarity) and tuck the wire in beside the battery. Re-install the battery cover and secure with screw.







## Operating Instructions

Note: Always ensure the transmitter is on when the car is on. To do this switch on the transmitter first before use and turn it off last.

The steering is controlled by the steering wheel, turn it anti-clockwise to turn left and clockwise to go right when driving forward. Reverse the steering when reversing.

The throttle trigger controls power to the wheels. Pull the trigger back to accelerate, release to coast without power and push forward to brake. When stationary push the trigger forward to engage reverse.

The diagrams on the right are a useful guide to what each control does.

This product is suitable for use on smoother surfaces such as tarmac, carpet or concrete. Do not use on rougher surfaces such as dirt, gravel and grass because they can cause too much friction and overheat the motor.

Do not drive the car until the battery is completely flat, this will greatly extend the cars usable life. When the car drives slowly, stop and re-charge the battery. When the power indicating led on the transmitter starts flashing replace the batteries immediately as the control range will be decreased.

Always switch off the car and transmitter after use to avoid draining the batteries further. After each use re-charge the battery before storage. Leaving the battery in an uncharged state will cause damage.

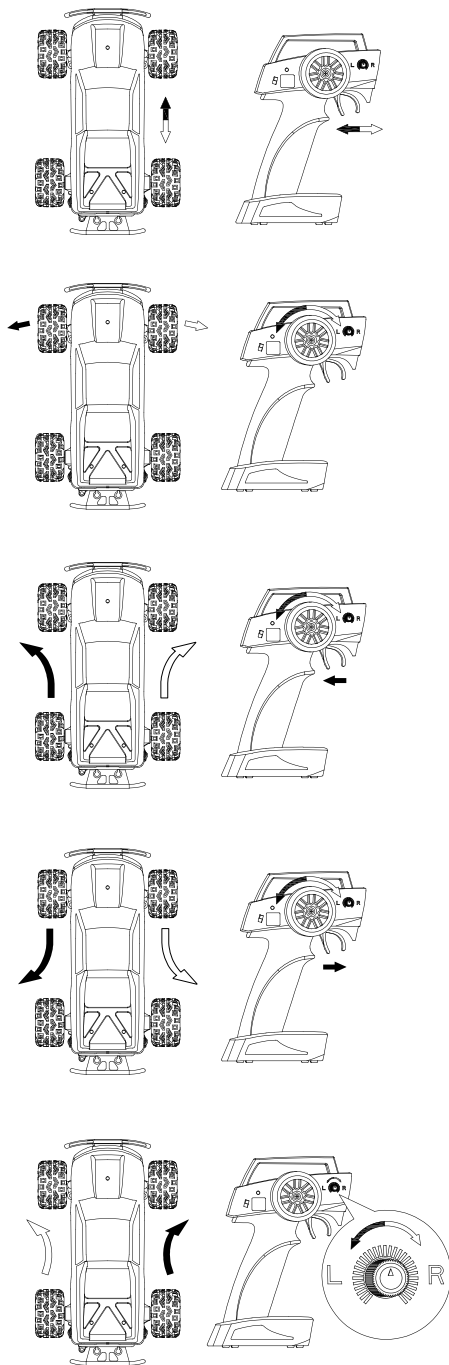



## Warranty

All Ripmax products are supplied with the legally prescribed 24 month warranty. If you want to make a warranty claim please consult with your dealer directly as they are a great source of knowledge and will be responsible for handling and dealing with Ripmax on your behalf. We will work to correct any operating deficiencies in manufacturing or material defects that are not related to over or incorrect use. Further claims such as consequent damage are not included in the warranty. You are responsible for the transportation of the product to an approved service centre. Prepaid shipments will not be accepted. We cannot assume liability for damage in shipping or the loss of your shipment. We therefore recommend an appropriate insurance.

To process your warranty claim please ensure the following:

- Please include a copy of your proof of purchase (receipt / invoice).
- You have used the product correctly in the non-commercial sector.
- You have only used the recommended power source and/or recommended accessories.
- The product is free of moisture damage, tampering, reversed polarity, overloads and mechanical damage.
- Please include a note with a concise report of the fault or defect to help our customer service team.

## Disclaimer

We have no control over the use of this product outside of the parameters of the instructions regarding methods of assembly/installation, operation, misuse and poor maintenance of the product or it's components. Therefore, we assume no liability for any loss, damage or costs arising from the improper use/operation. Ripmax shall not be liable for any loss, consequential loss, damage or expense arising from the improper use or operation or in any way as permitted by law. Ripmax are only liable to pay compensation, regardless of the legal reason, an amount limited to the invoice value of product affected directly in the event of any damage occurred.

## WEEE (Waste Electrical and Electronic Equipment)



This symbol means that electrical and electronic equipment at the end of their service life should not be disposed of in household waste and must be disposed of by the correct method. The best way to dispose of this equipment is at your local municipal collection point or recycling centre. This applies to all countries of the European Union and in other European countries with separate collection programs.

## Waste Battery Disposal



This symbol means that all batteries at the end of their service life should not be disposed of in household waste and must be disposed of by the correct method. The best way to dispose of this equipment is at your local municipal collection point or recycling centre. This applies to all countries of the European Union and in other European countries with separate collection programs.

## Regulatory Information

**CE** Ripmax Ltd. declares that this product is in compliance with the essential requirements and other relevant provisions of the relevant EU directives. The original declaration of conformity can be found on the internet at [www.ripmax.com](http://www.ripmax.com) in the respective device description as the "Declaration of Conformity".

Made in China

Distributed to your local model shop by:

Ripmax Ltd., 241 Green Street, Enfield, EN3 7SJ. United Kingdom.

