

Backplate Sensor For Governor

BPS-1

Instruction Manual

Thank you for buying a BPS-1 Backplate Sensor for governor. Before using your new sensor, please read this manual together with the instruction manuals of the governor, transmitter, and engine used and use the BPS-1 properly. After reading this manual, store it in a safe place.

- **The BPS-1 is designed for use with Futaba GY701, CGY750, and GV-1 governors.**
- **The BPS-1 can be used only with a BPS-1 compatible engine backplate.**

⚠ WARNING

- ❗ **Always use the BPS-1 with a BPS-1 compatible engine backplate.**
- ❗ **Be careful of the connector polarity.**
 - Because of the case construction, reversing the polarity may cause trouble or sparking from the wiring.
- ❗ **Mount the BPS-1 when the engine is sufficiently cool.**
 - If you touch the engine immediately after use, you may receive a burn.
- ❗ **Mount the sensor in accordance with the installation method described below.**
 - If the BPS-1 drops out during flight, it causes erratic operation or loss of control.

- ❗ **Vibration-proof the PC board and mount the BPS-1 where it will not be exposed to fuel and water.**
 - Electronic parts are used at the PC board. Take protective measures against vibration, shock, high temperature, and so forth.
- ❗ **When mounting the BPS-1 to the fuselage, be sure there is some slack in the wiring cable.**
 - If the cable is too tight, vibration may cause the wire to break or the connector to be dislodged and cause a malfunction.
- ❗ **Always perform an operation check after assembling.**
 - Do not fly until inspection is complete.
- ⊘ **Do not use the BPS-1 with anything other than an R/C model helicopter.**

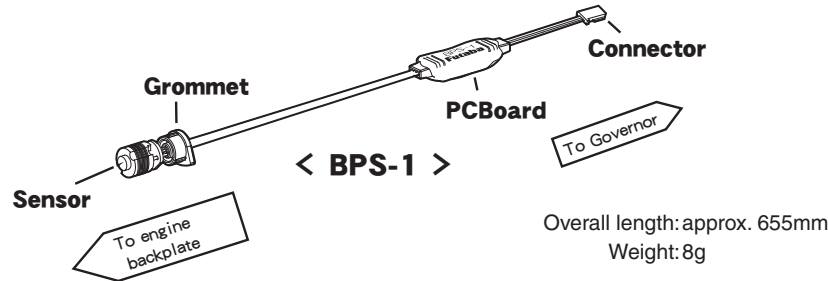

Installation Method

- 1 Degrease the engine backplate with alcohol, etc.**

*Oil residue on the backplate will cause faulty adhesion.

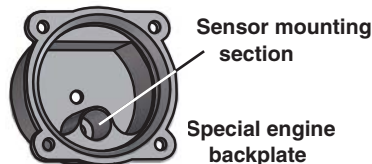

- 2 Inject silicone resin into the special engine backplate up to about 1/3 (approximately 0.3cc) from the bottom of the sensor mounting section of the backplate.**

*Use non-solvent alcohol-release type silicone adhesive.

- 3 Insert the sensor perpendicularly and push in the grommet fully.**

*Until adhesive is squeezed out from the grommet is a sufficient.

- 4 Wipe off the squeezed out adhesive.**

*So that the adhesive does not enter the engine. Adhesive in the engine will cause engine trouble.

- 5 Fasten the grommet so that it will not move and allow the adhesive to harden.**

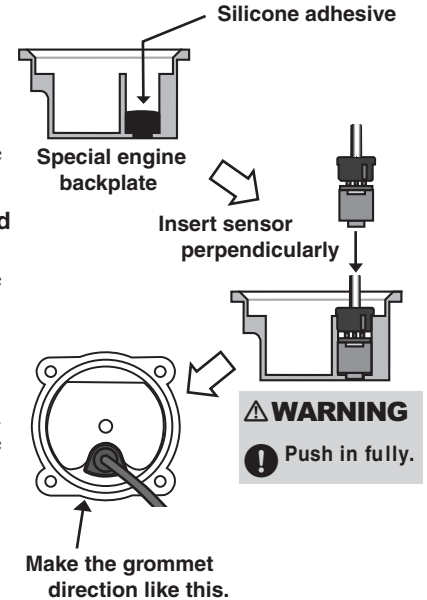

Operation Check

After assembling is complete, check operation as follows:

- 1 Connect the sensor to the governor used and call the governor revolution sensor test screen. (Revolution sensor monitor for the GV-1.)**

*Connect and operate the sensor in accordance with the governor instruction manual.

- 2 Using a starter, rotate the engine without starting it and check if the sensitivity is 60% or greater.**

*Rotate with only the starter without plug heater attached.

*If the sensitivity is less than 60%, re-check the installation.

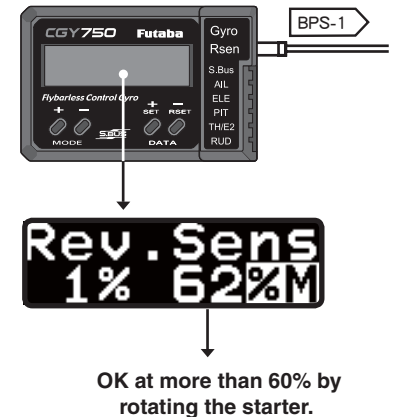

FUTABA CORPORATION

1080 Yabutsuka, Chosei-mura, Chosei-gun, Chiba-ken, 299-4395, Japan
Phone: +81 475 32 6982, Facsimile: +81 475 32 6983